

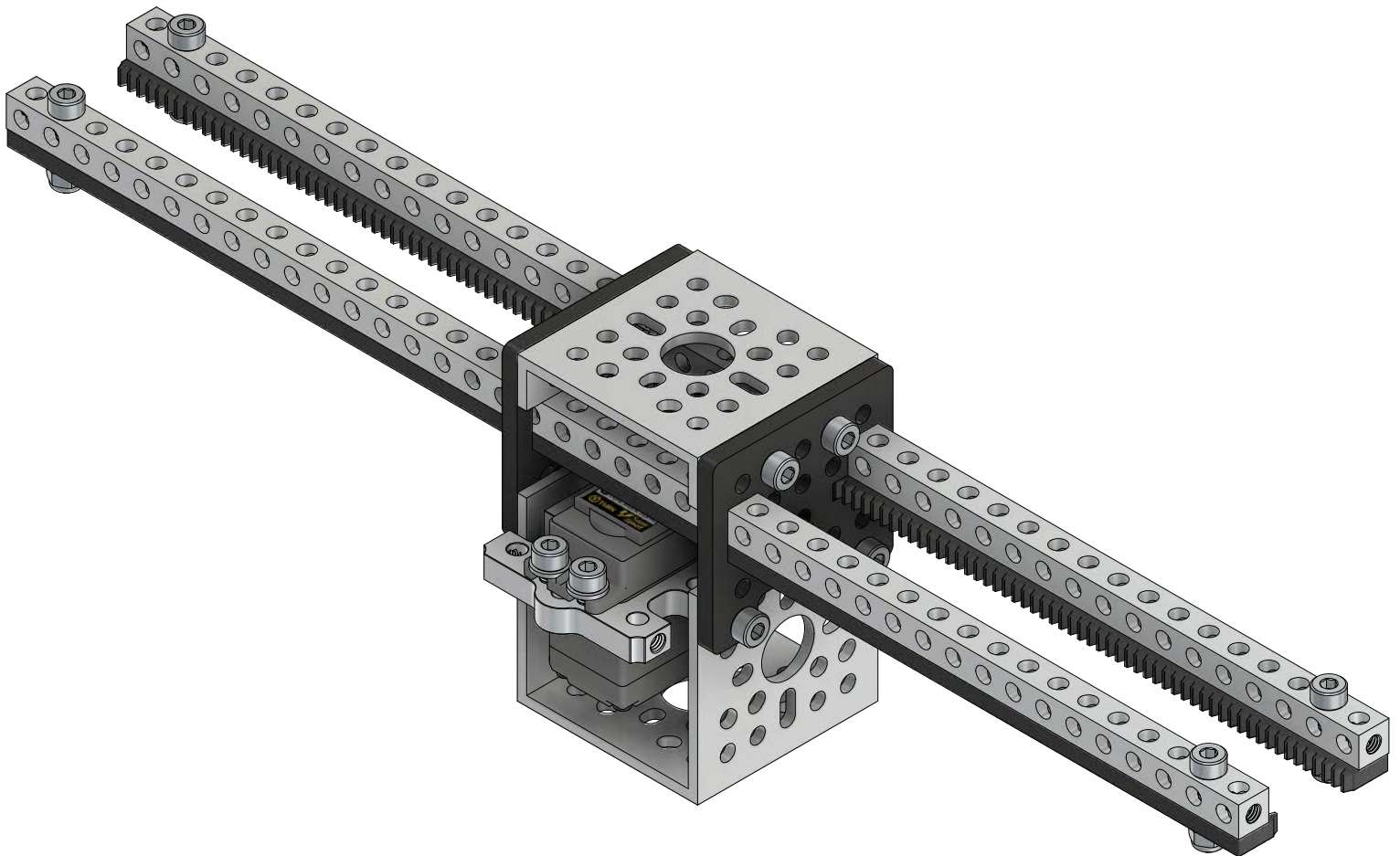

Assembly Instructions for
Servo-Driven Gear Rack Kit
(Dual Gear Rack)
SKU: 3207-0003-0002



Kit Contents

Tools Required

- 2.5mm Hex Key
- 3mm Hex Key
- 7mm Nut Driver

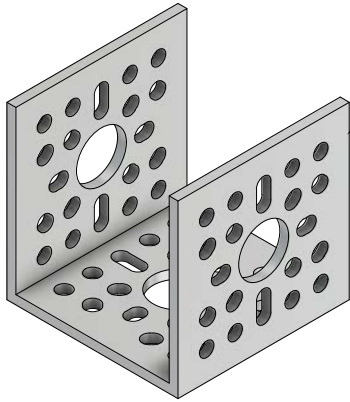

1-Hole U-Channel
SKU: 1120-0001-0048
QTY: 1

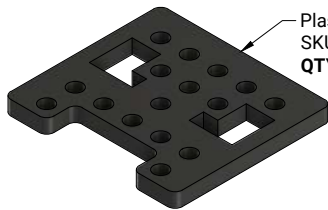

Plastic Grid Bracket
SKU: 1133-0001-0001
QTY: 2

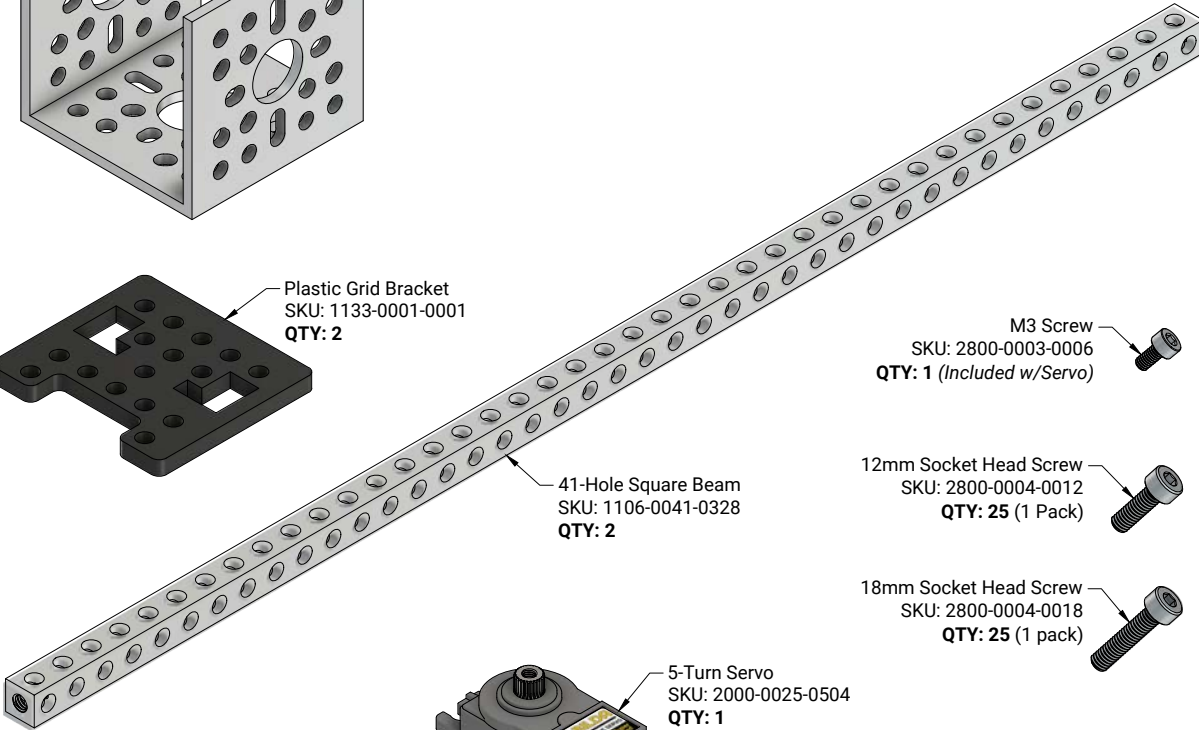

41-Hole Square Beam
SKU: 1106-0041-0328
QTY: 2

M3 Screw
SKU: 2800-0003-0006
QTY: 1 (Included w/Servo)

12mm Socket Head Screw
SKU: 2800-0004-0012
QTY: 25 (1 Pack)

18mm Socket Head Screw
SKU: 2800-0004-0018
QTY: 25 (1 pack)

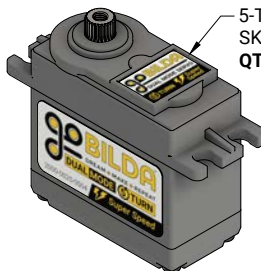

5-Turn Servo
SKU: 2000-0025-0504
QTY: 1

131 Tooth Gear Rack
SKU: 2311-0001-0131
QTY: 2

Locknut
SKU: 2812-0004-0007
QTY: 25 (1 Pack)

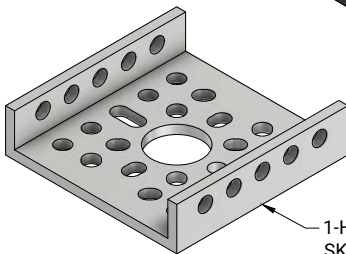

1-Hole Low-Side U-Channel
SKU: 1121-0001-0048
QTY: 1

Servo Frame (w/Hardware)
SKU: 1802-0043-0001
QTY: 1

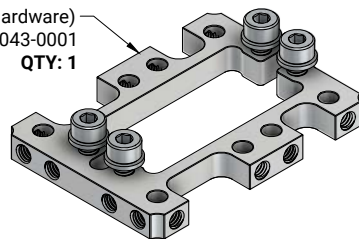

24 Tooth Servo Gear
SKU: 2305-0025-0024
QTY: 1

STEP 1:

Attach **one** Servo Frame to **one** 5-Turn Servo using **four** 12mm Socket Head Screws and **four** washers (included with Servo Frame) as shown. Install **one** 24 Tooth Servo Gear using **one** M3 Screw (included with Servo).

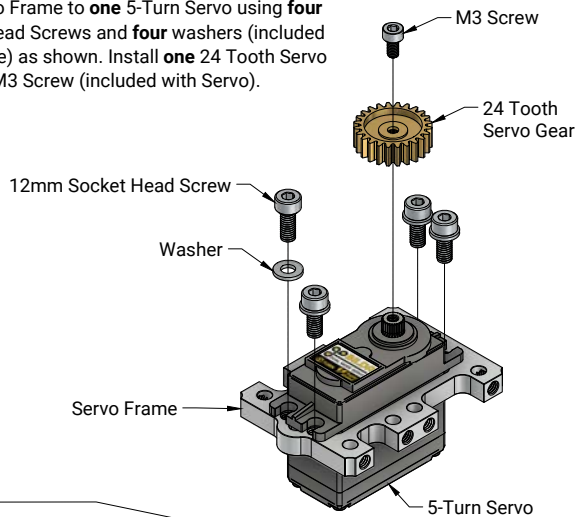

STEP 2:

Using **four** 12mm Socket Head Screws and **four** Locknuts, attach **two** Plastic Grid Brackets to **one** 1-Hole Low-Side U-Channel as shown.

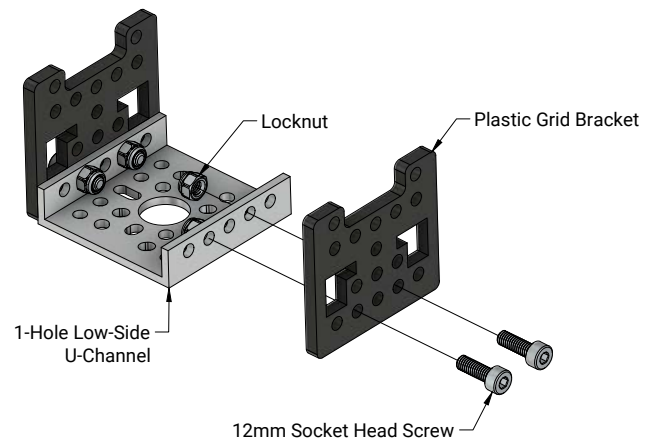

STEP 3: — Gear Rack Subassemblies

Attach **two** 131 Tooth Gear Racks to **two** 41-Hole Square Beams using **two** 18mm Socket Head Screws and **two** Locknuts as shown.

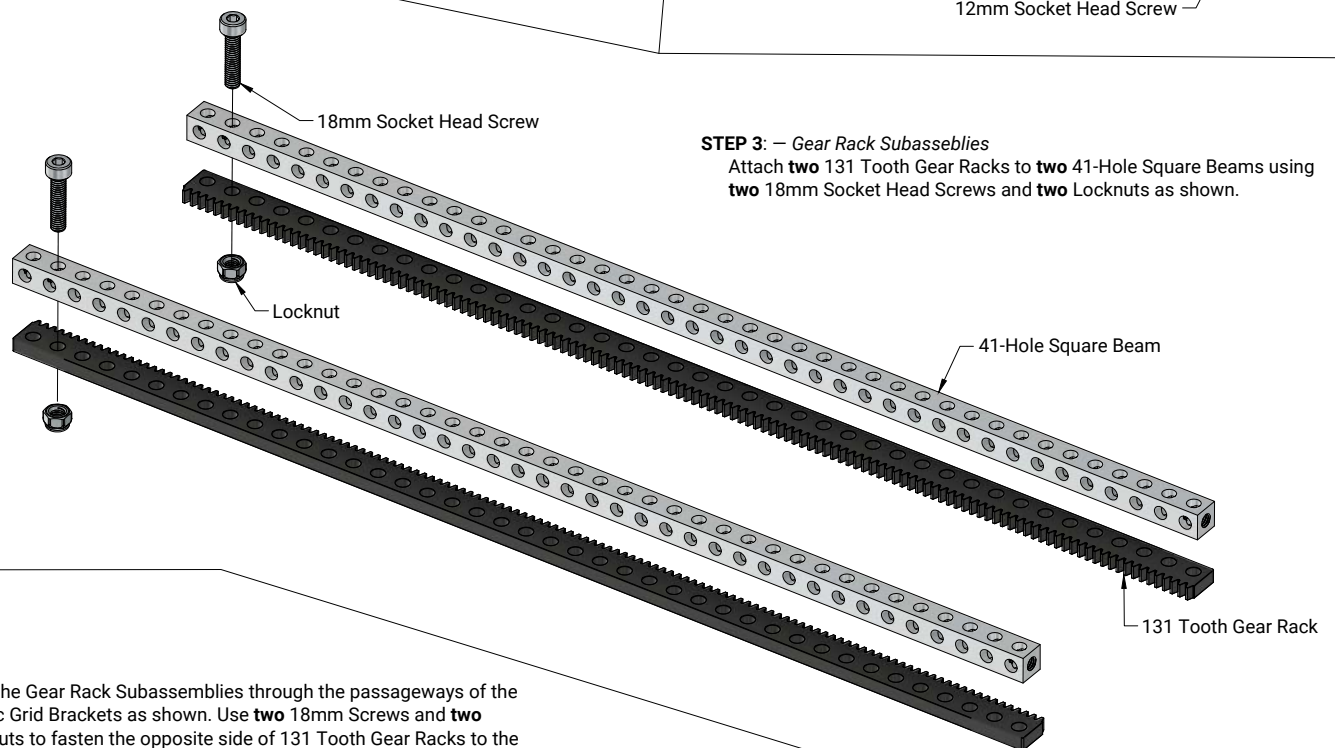

STEP 4:

Slide the Gear Rack Subassemblies through the passageways of the Plastic Grid Brackets as shown. Use **two** 18mm Screws and **two** Locknuts to fasten the opposite side of 131 Tooth Gear Racks to the 41-Hole Square Beams.

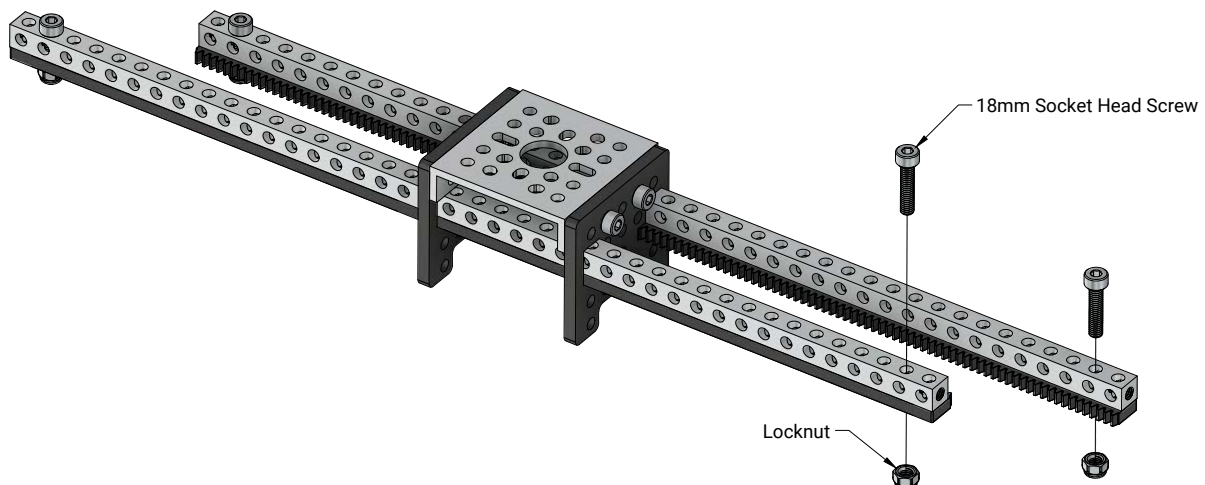

STEP 5:

Center both Gear Racks so that four temporary screws can be inserted into the Square Beams as shown to keep it centered while completing **STEP 6**.

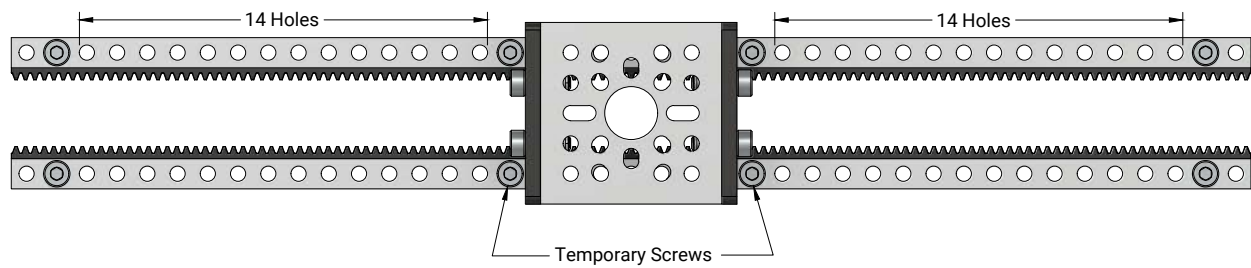
**STEP 6:**

Plug the servo into your servo controller and center the servo by sending a 1500 μ s PWM signal (**Figure 6-A**), then unplug the servo.

Attach the Servo Sub-Assembly using **four** 12mm Socket Head Screws as shown.

Remove the Temporary Screws.

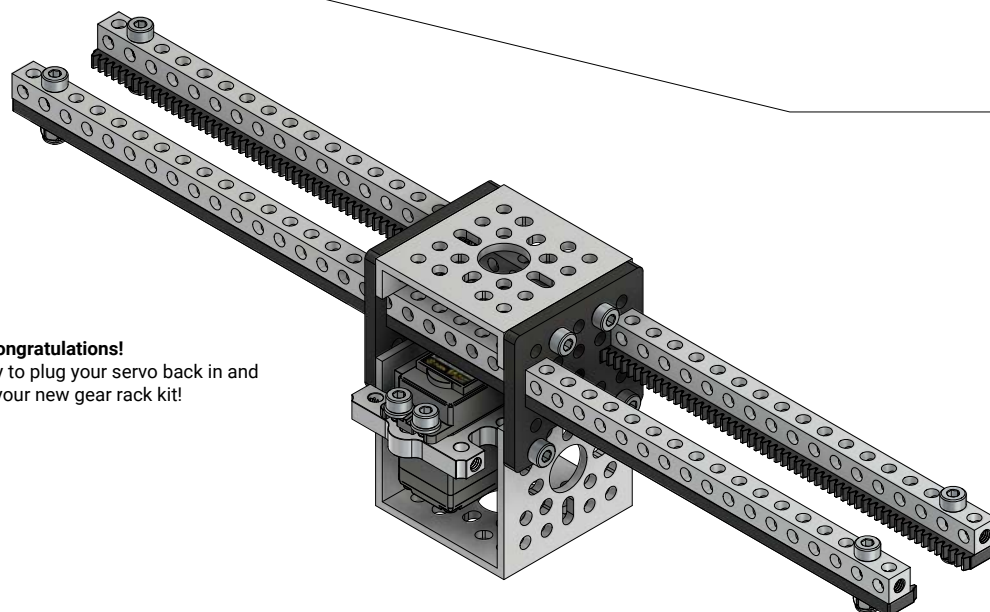
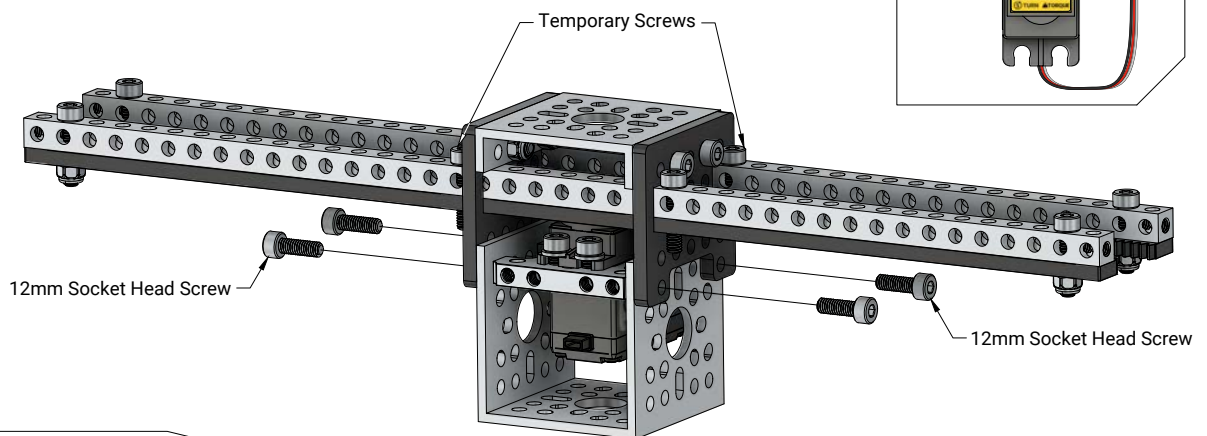
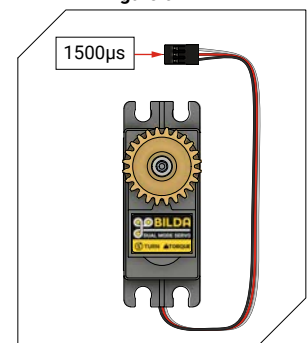
Figure 6-A**Congratulations!**

You are now ready to plug your servo back in and test out your new gear rack kit!